

INTERVENCIONES BAÑOS Y CAMARINES GIMNASIO

BAÑO DAMAS INTERIOR

INSTALACIÓN DE PORCELANTO

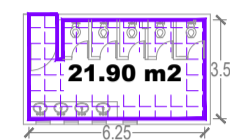

RETIRO Y REPOSICIÓN DE PUERTAS Y VENTANAS

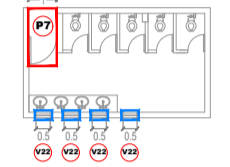

RETIRO Y COLOCACIÓN DE CERÁMICO DE MURO

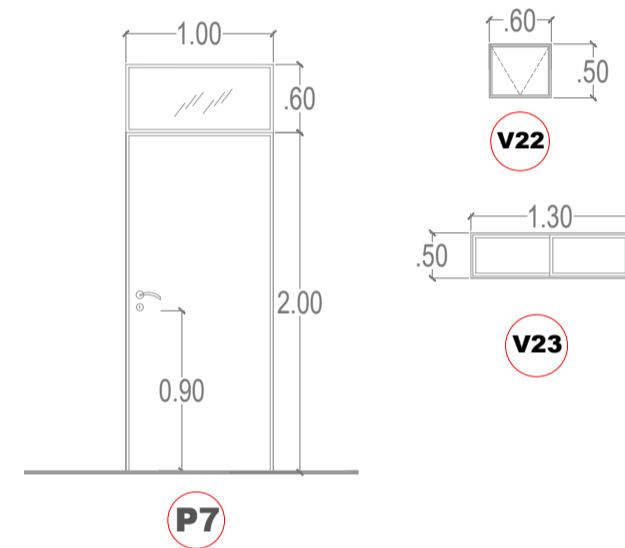
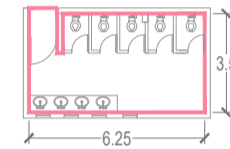

PREPARACION DE SUPERFICIES Y PINTURA DE MURO

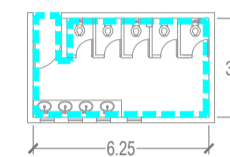

PREPARACION DE SUPERFICIES Y PINTURA DE CIELO

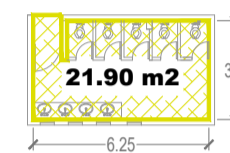

RETIRO Y COLOCACIÓN DE LUMINARIAS

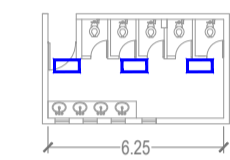

RETIRO Y COLOCACIÓN DE ARTEFACTOS SANITARIOS

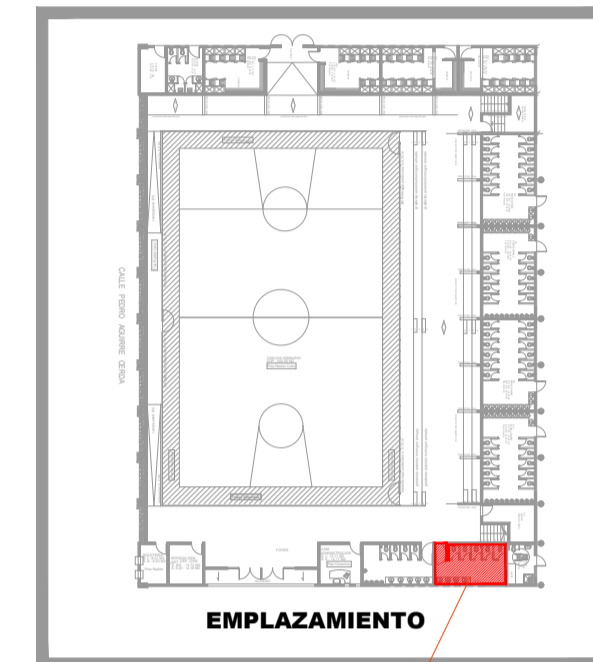
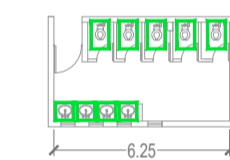

BAÑOS DAMAS (INTERIOR)

ADMINISTRACIÓN

RETIRO Y REPOSICIÓN DE PUERTAS Y VENTANAS

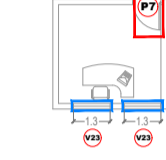

PREPARACION DE SUPERFICIES Y PINTURA DE MURO

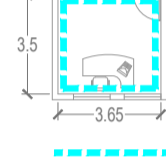

PINTURA INTERIOR

PREPARACION DE SUPERFICIES Y PINTURA DE CIELO

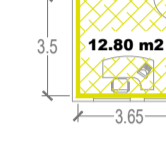

RETIRO Y COLOCACIÓN DE LUMINARIAS

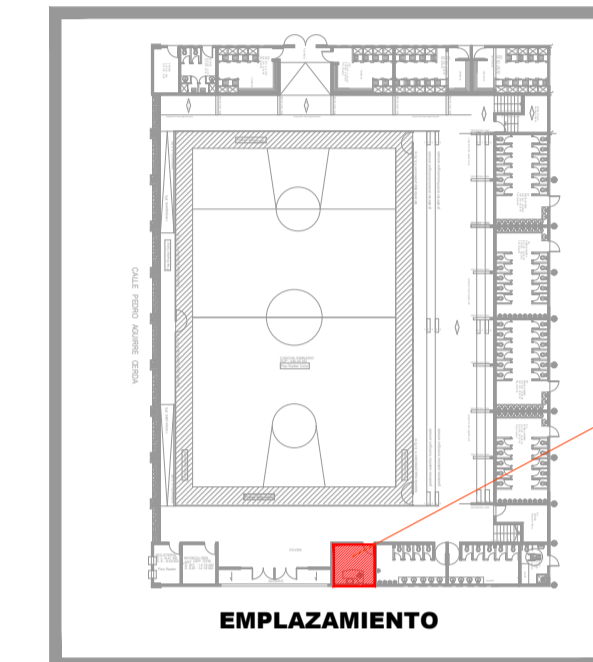
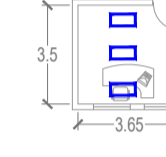

ADMINISTRACIÓN

BAÑO VARONES INTERIOR

INSTALACIÓN DE PORCELANTO



RETIRO Y REPOSICIÓN DE PUERTAS Y VENTANAS

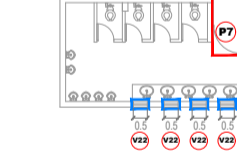

RETIRO Y COLOCACIÓN DE CERÁMICO DE MURO

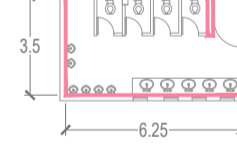

PREPARACION DE SUPERFICIES Y PINTURA DE MURO

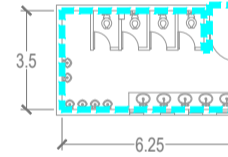

PREPARACION DE SUPERFICIES Y PINTURA DE CIELO

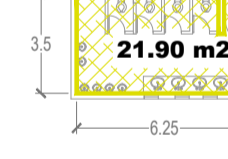

RETIRO Y COLOCACIÓN DE LUMINARIAS

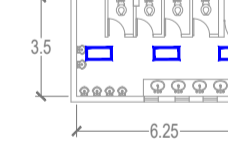

RETIRO Y COLOCACIÓN DE ARTEFACTOS SANITARIOS

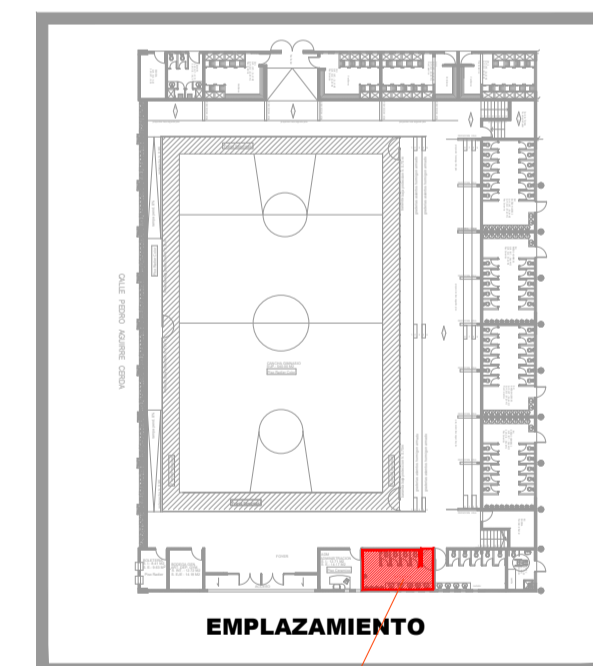
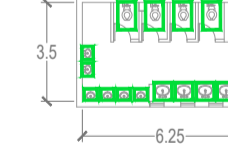

BAÑOS VARONES (INTERIOR)

BODEGA I

RETIRO Y REPOSICIÓN DE PUERTAS Y VENTANAS

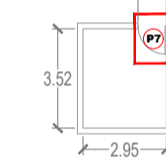

PREPARACION DE SUPERFICIES Y PINTURA DE MURO

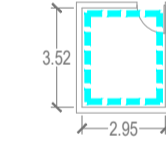

PREPARACION DE SUPERFICIES Y PINTURA DE CIELO

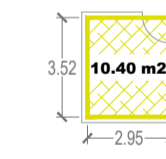

RETIRO Y COLOCACIÓN DE LUMINARIAS

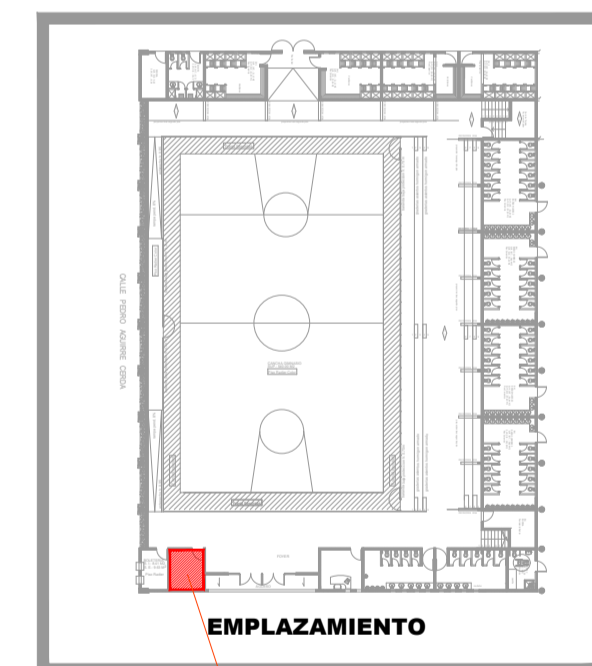
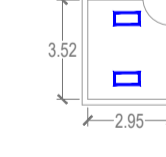

BODEGA (I)

BOLETERIA

RETIRO Y REPOSICIÓN DE PUERTAS Y VENTANAS

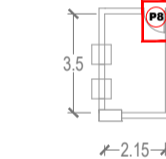

PREPARACION DE SUPERFICIES Y PINTURA DE MURO

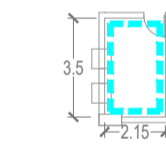

PREPARACION DE SUPERFICIES Y PINTURA DE CIELO

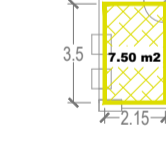

RETIRO Y COLOCACIÓN DE LUMINARIAS

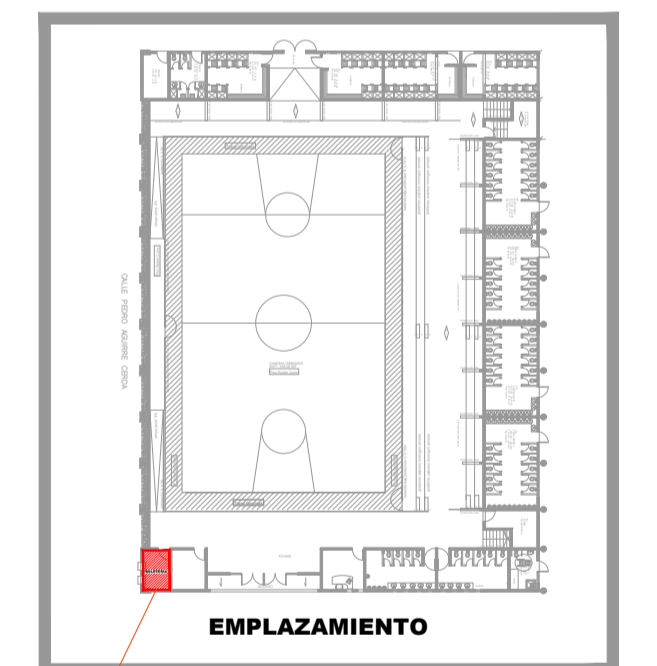
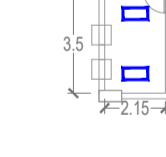

BOLETERIA

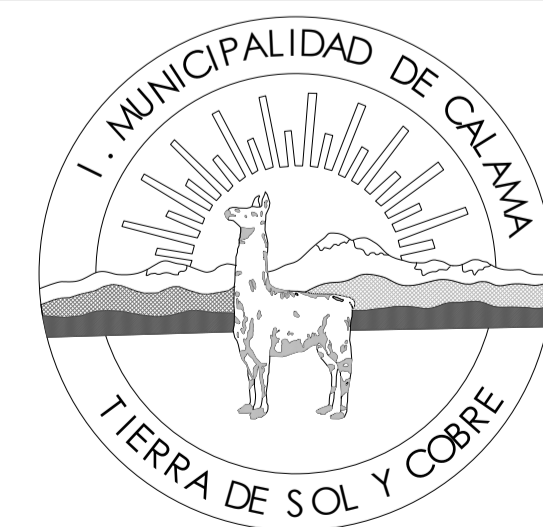

PLANO DE UBICACION:



Corporación Municipal de Desarrollo Social de Calama

ILUSTRE MUNICIPALIDAD DE CALAMA
CORPORACION MUNICIPAL DE DESARROLLO SOCIAL DE CALAMA

Arquitecto
Angelica Pasten Alvarez.

RUT: 14.309.280-1

CONSERVACION LICEO FRANCISCO DE AGUIRRE, CALAMA

UBICACIÓN: ANIBAL PINTO 2278, CALAMA

Contenido
Formato A 1
Sin Escalas

- Plano de intervenciones baños y camarines Gimnasio

FECHA:
SEPTIEMBRE 2022

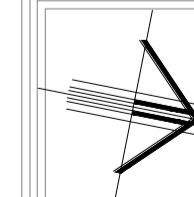

JEFE UNIDAD PLANIFICACIÓN : Ernesto Luttino Rojas.
ENCARGADO PROYECTO : Carlos Brito Contreras.
DIBUJO : Jennifer Parra Opazo.
CODIGO BIP : 40027662

LAMINA:
ARQ 11
11 de 20 Rev.0